

CL25 SERIES DIMENSIONS

Oldham Coupling

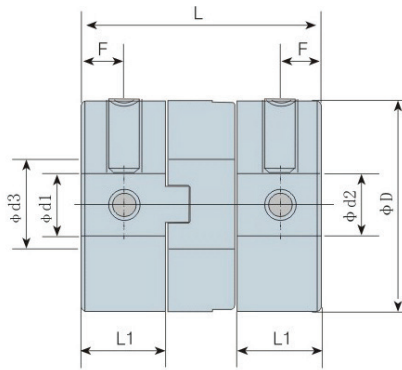

Setscrew Type

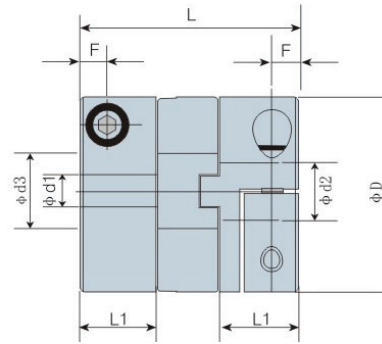
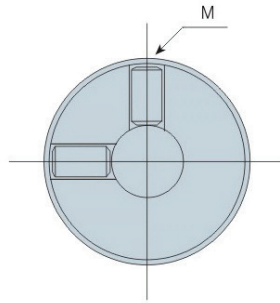

Clamp Type

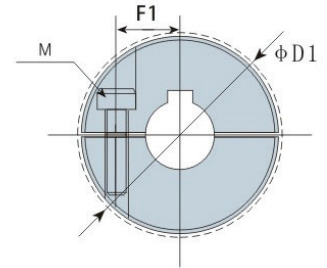

MODEL	BORE RANGE (ØD1, ØD2)				ØD	ØD1	ØD3	L		F		L1	F1		M		WRENCH TORQUE	
	SETSCREW		CLAMP		SET-SCREW & CLAMP	CLAMP	CLAMP	SET-SCREW	SET-SCREW	CLAMP	CLAMP	SET-SCREW & CLAMP	SET-SCREW & CLAMP	SET-SCREW	CLAMP	SET-SCREW	CLAMP	
	IN	mm	IN	mm	mm	mm	mm	mm	mm	mm	mm	mm	mm	mm	METRIC	METRIC	Nm	Nm
CL25-C12	0.12 - 0.23	3 - 6			12			6.5	15			5.2		M2.5		0.5		
CL25-15, CL25-15 WP	0.12 - 0.31	3 - 8	0.12 - 0.23	3 - 6	15	17	8.5	6.5	17	19	2.8	2.7	5.6	5.2	M3	M2	0.7	0.4 - 0.5
CL25-17, CL25-17 WP	0.16 - 0.39	4 - 10	0.16 - 0.25	4 - 6.35	17	18	10.5	7	21	25	3.5	3.1	7	5.5	M3	M2.5	0.7	1.0 - 1.1
CL25-20, CL25-20 WP	0.20 - 0.47	5 - 12	0.20 - 0.39	5 - 10	20	23.5	12.5	10.5	22	28	3.5	4.0	7	7.25	M3	M3	0.7	1.5 - 1.9
CL25-26, CL25-26 WP	0.24 - 0.59	6 - 15	0.24 - 0.47	6 - 12	26	29	15.5	12.5	27	32	4.5	4.7	9	9	M4	M4	1.9	3.4 - 4.1
CL25-30, CL25-30 WP	0.31 - 0.71	8 - 18	0.31 - 0.55	8 - 14	30	32.5	18.5	14.5	34	34	6	4.7	12	11	M4	M4	1.9	3.4 - 4.1
CL25-34, CL25-34 WP	0.39 - 0.78	10 - 20	0.39 - 0.62	10 - 16	34	35	20.5	16.5	35	35	6.5	5.0	13	12	M5	M4	3.7	3.4 - 4.1
CL25-38, CL25-38 WP	0.39 - 0.87	10 - 22	0.39 - 0.78	10 - 20	38	40.5	22.5	20.5	41	41	7.5	5.6	15	14	M5	M5	3.7	7.0 - 8.5
CL25-45, CL25-45 WP	0.47 - 0.98	12 - 25	0.47 - 0.87	12 - 22	45	50.5	25.5	22.5	45	48	7.5	6.5	15	16	M5	M6	3.7	14 - 15
CL25-55, CL25-55 WP	0.59 - 1.18	15 - 30	0.59 - 0.98	15 - 25	55	60	28.5	25.5	51	59	8.5	7.8	17	20	M6	M8	6.3	27 - 30
CL25-70, CL25-70 WP	0.71 - 1.65	18 - 42	0.71 - 1.38	18 - 35	70	80	42.5	35.5	59	69	10	9.8	20	26	M8	M10	15	55 - 60

(1) For other bore sizes which are not listed above, customized ones are available, please consult us. (2) Standard bore tolerance is for the shaft with tolerance h7 or h8; if other tolerance is required, please consult us.