

CH SERIES FLANGE SHAFT DIMENSIONS

Precision Planetary Gearbox

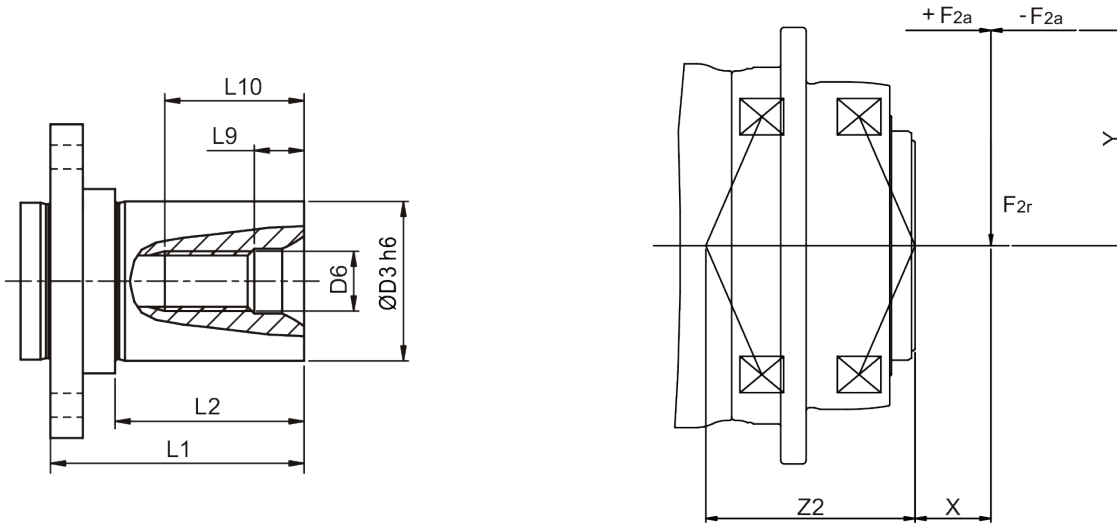

$$M_{2K} = \frac{F_{2a} * Y + F_{2r} * (X + Z2)}{1000}$$

M_{2K} : [Nm]

F_{2a}, F_{2r} : [N]

$X, Y, Z2$: [mm]

DIMENSION	L1	L2	D3 (H6)	D6	L9	L10	ORDER CODE
CH064	33	23	16	M5	4.8	12.5	FLS-CH064-S16
			22	M8	7.2	19	FLS-CH064-S22
CH090	41	30	22	M8	7.2	19	FLS-CH090-S22
			32	M12	10	28	FLS-CH090-S32
CH110	51	38	32	M12	10	28	FLS-CH110-S32
			40	M16	12	36	FLS-CH110-S40
CH140	54	38	40	M16	12	36	FLS-CH140-S40
			55	M20	15	42	FLS-CH140-S55
CH200	73	52	55	M20	15	42	FLS-CH200-S55
			75	M20	15	42	FLS-CH200-S75
CH255	150	123	90	M24	18	50	FLS-CH255-S90

(1) Dimensions are related to gearbox flange interface.

M2K

CH	064	090	110	140	200	255	285	355	450
Z2 (mm)	63.7	84.5	106.2	90	122.8	133.2	175.5	220.6	275.3

(1) Applied to the output flange center at 100 rpm..